



## OPERATING INSTRUCTIONS

1. Install 8 "AA" batteries (not included) as shown in (Diagram 1) and replace the battery door. Dry the bubble solution on the battery door surface before opening it to avoid bubble solution going into the battery compartment.  
Note: Use Alkaline Battery only
2. Remove cap and foil seal from Bubble Solution Container. (Diagram 2)
3. Line up the machine unit on top of the solution container. Be sure the plastic tube is inside the Container. (Diagram 3)
4. Tighten the strap on both sides. (Diagram 4)
5. Press the button to start the Typhoon. (Diagram 5) Bubble solution will be pumped over rotating wands. Bubbles will start to appear after approximately 15 seconds of operation.

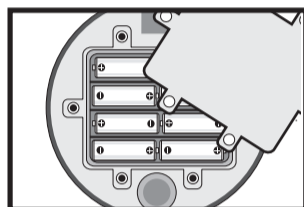

Diagram 1



Diagram 2



Diagram 3

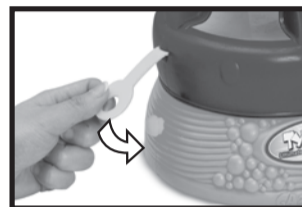

Diagram 4



Diagram 5

## CLEANING

1. In order to keep your machine working properly, be sure to clean it out with warm water after every use. Failing to do so may lead to solution build up and render the machine inoperative!
2. Lift the Typhoon from the solution container and replace container cap. (Diagram 6)
3. Using a small container filled with warm water, insert the plastic tube into the water and press the button to pump water through the mechanism inside the machine (Diagram 7).
4. Allow the pump to run until you see water flowing through the wands above. Continue to run for approximately 60 seconds. (Diagram 8)



Diagram 6



Diagram 7

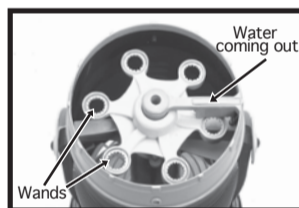

Diagram 8

## STORAGE

1. Store the plastic tube inside the empty space in the middle of the Typhoon. (Diagram 9)

## PRECAUTIONS

DO NOT immerse the machine into water.

## TROUBLE SHOOTING

Problem	Action
1. The bubble wands are not moving	<p>Using Batteries:</p> <ul style="list-style-type: none"> <li>- Check to make sure the batteries are correctly installed.</li> <li>- Check to make sure the batteries are not exhausted, batteries may need to be replaced by new ones.</li> <li>- Clean the machine as instructed in the CLEANING section.</li> </ul> <p>Using AC adaptor:</p> <ul style="list-style-type: none"> <li>- Make sure the plug of your AC adaptor has been firmly inserted into the Typhoon socket.</li> <li>- Check whether your AC adaptor has been plugged correctly into your AC power supply. (Diagram 10)</li> </ul>
2. The machine is running but there are no bubbles	<ul style="list-style-type: none"> <li>- Use a narrow tool, like a toothpick to remove the bubble solution residue retained on the wands (bubble solution will leave a residue on the wands if the machine is not properly cleaned after play) (Diagram 11), and then clean the machine as instructed in the CLEANING section.</li> </ul>

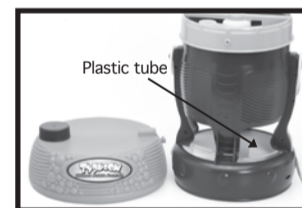

Diagram 9



Diagram 10



Diagram 11

## Important Note:

1. For best results, only use Gazillion® Solution, funnel included for use when refilling.
2. Bubble solution may spill and residue from bubbles may create a slippery surface, all care should be taken to avoid such situations.
3. The Typhoon produces massive amounts of bubbles. Care should be taken to place the unit away from anything you don't want to be get wet.
4. Please retain for future reference.